

Each of the four separate dwelling units follow this floorplan and two additional dwellings in the basement.

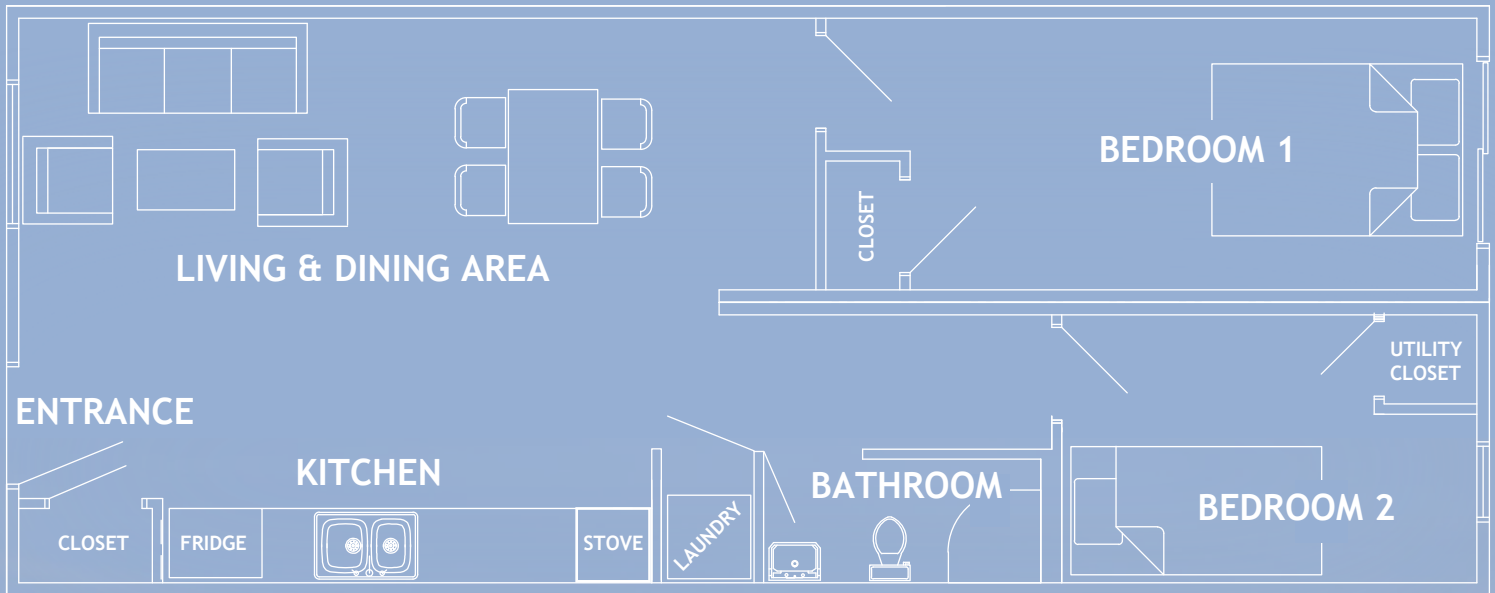



Presented here are two views of the kitchen. We can clearly see the cabinets, granite counter top, stove, microwave and refrigerator. In the photo on the left we see the hallway leading to a bedroom. In the photo on the right, we see the main entrance along with the front hall closet.

In the photos below, we see how the kitchen extends into the living and dining area. The main bedroom has a large sliding door and juliette balcony, to allow maximum light into the room. Note the stacked washer and dryer in the laundry closet, which are included in each dwelling.



Family Services Windsor-Essex is now able to use this property in order to help people to restore their ability to choose their own place in the world.

